

Galion™ 45A Cooker Unit

Cat. No(s): 2 824 25

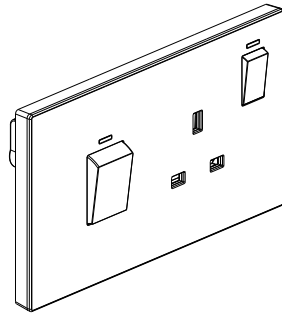

2 824 25

CONTENTS

1. Use.....	1
2. Range.....	1
3. Preparation.....	1
4. Overall dimensions.....	1
5. Connection.....	2
6. Technical characteristics.....	2
7. Cleaning.....	2
8. Conformity - Approvals.....	2

1. USE

High capacity double pole switches for the control of fixed appliances eg. cooker ovens units, and 13A BS switched socket, available with LED "power on" indicator.
(Supplied with M3.5 screws for BS boxes. Flush mounting or Surface mounting.)

2. RANGE

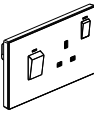
	Designation	Cat. No.	Weight (g)	Characteristics
	45A Cooker Unit	2 824 25	150	45 A - 250VAC

Colours

- Front: white/rose golden/champagne/dark silver
- Rear: white/rose golden/champagne/dark silver
- X XXX XX White
- X XXX XX-C Matt black
- X XXX XX-C1 Rose golden

3. PREPARATION

3.1 General preparation for 1G switch

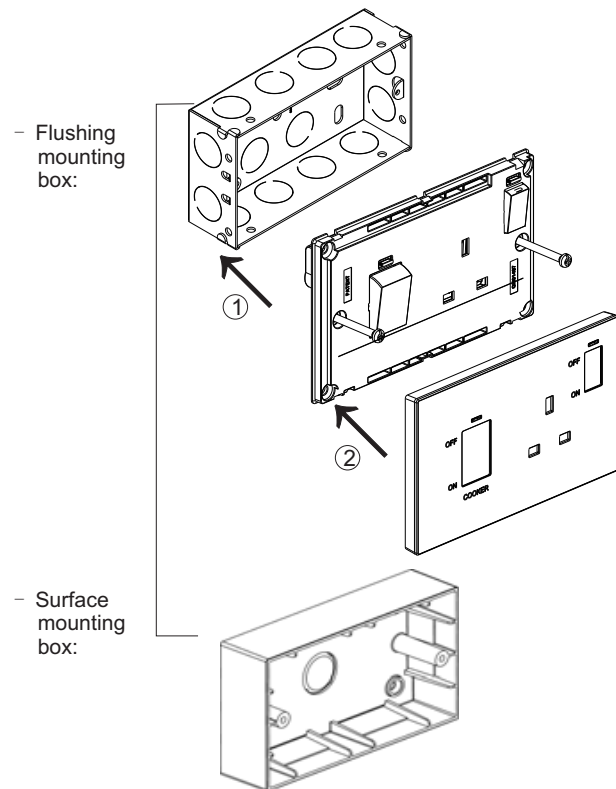

4. OVERALL DIMENSIONS

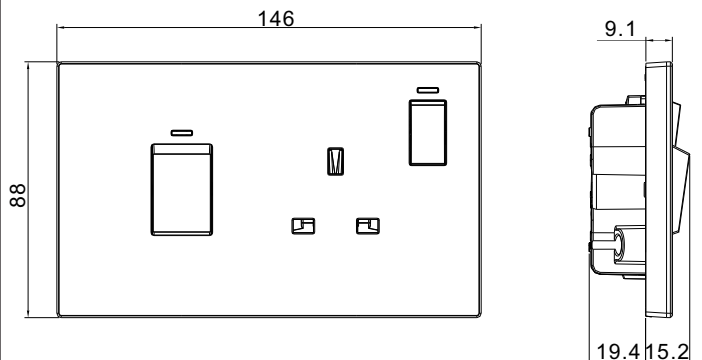

Profile Size: 146 × 88 mm
Distance of installation hole: 120.6 mm

5. CONNECTION

5.1 Terminals

Terminal capacity: 2 × 6 mm²
1 × 10 mm²

Recommended screwdriver size: 4 mm flat blade
Recommended stripping length: 20 mm

5.2 Circuit diagrams

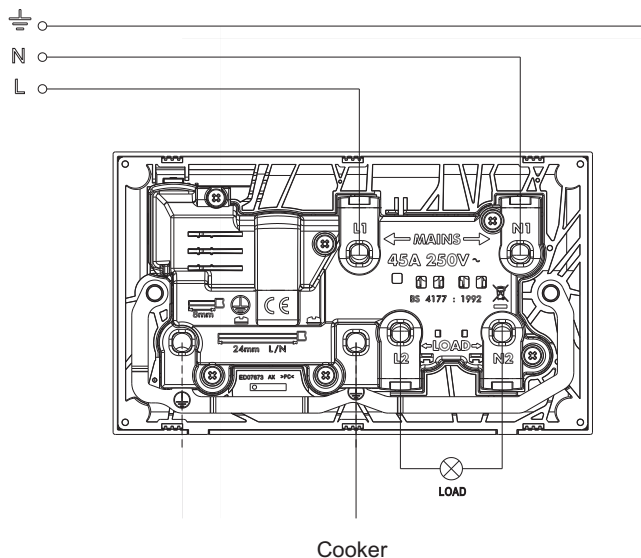

6. TECHNICAL CHARACTERISTICS

6.1 Material characteristics

Cover plate: Polycarbonate
Rocker: Polycarbonate
Frame: Polycarbonate
Base: PC
Self-extinguishing:
+ 850° C / 30 s for insulating parts holding live parts in place
+ 650° C / 30 s for other parts made of insulating materials

6.2 Electrical characteristics

Voltage: 250VAC
Current: 45A

6.3 Climatic characteristics

Storage temperatures: -10°C to +70°C
Operating temperatures: -5°C to +50°C

6.4 Mechanical characteristics

Impact test: IK04
Protection against liquids: IP20

7. CLEANING

Surface cleaning with a soft, slightly damp cloth.
Do not use: acetone, tar remover, trichloroethylene

8. CONFORMITY - APPROVALS

Conform to IEC 60669-1; IEC 60884-1.